

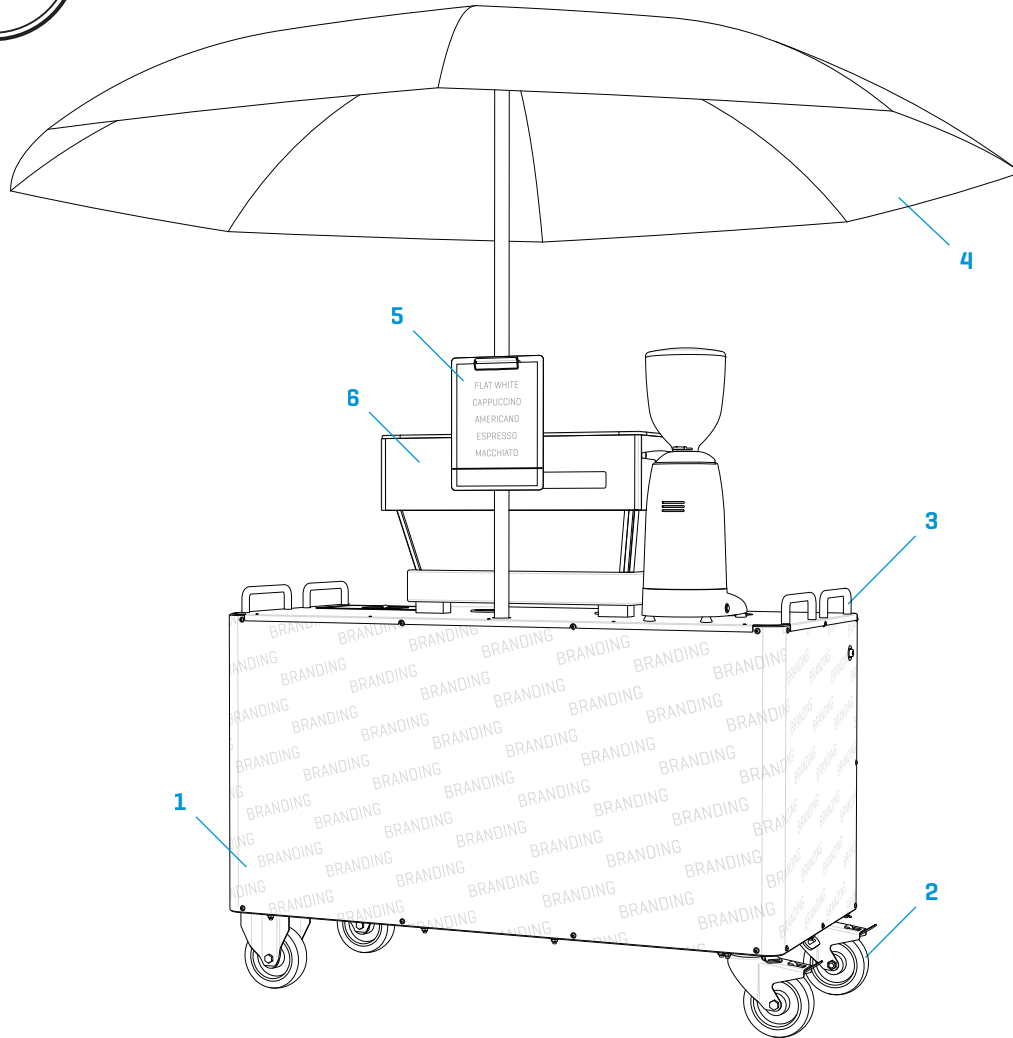

POP-UP BAR SPECIFICATION



The POP-UP BAR is an innovative, precision-engineered bar on large, industrial castor wheels. Designed to be used primarily with commercial 1 and 2 group espresso machines and grinders, the bar can also be fitted with beverage dispense towers ('beer taps') for hot or cold drinks. At only 1.45m (57") long x 0.7m (27.5") wide it is small enough to be wheeled through any doorway and loaded into elevators and small vans, but large enough to offer full functionality without compromise. It can be operated inside or outside, on electric mains or gas cylinder and battery, depending on the preferred coffee machinery. The POP-UP BAR provides over 2 square metres of wrap-around branding, and can be re-branded in minutes.

- 1** Branding panels: over 2 square metres for your branding, digitally printed, full-colour, weatherproof, fire-retardant panel, bolt-on
- 2** Castors: 2 fixed & 2 lockable swivel castors, Ø160mm
- 3** Hand-rails: architectural hand-rails (x4), brushed stainless steel (304), Ø19mm, bolt-on
- 4** Umbrella*: Ø2.4m (8') water and UV-proof canopy, fibreglass frame, aluminium pole
*recommended accessory
- 5** Menu*: aluminium clip-board, fits A4 / US letter size menus, clips on to umbrella pole
*recommended accessory
- 6** Coffee machinery: your preferred equipment*
*machine packages available - see Price List

STANDARD BAR

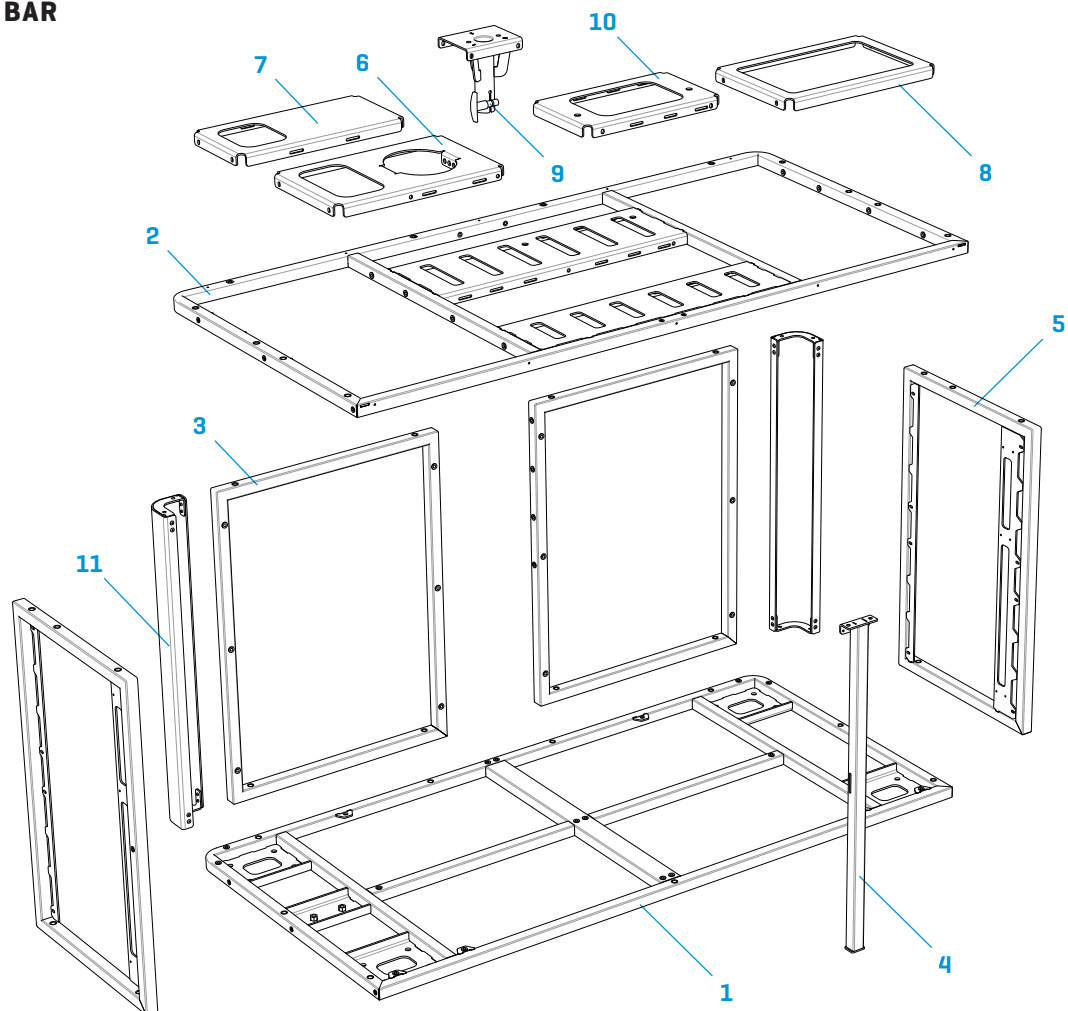

At the heart of the POP-UP BAR is the super-strong steel frame consisting of precision laser-cut and TIG-welded modules that are bolted together.

The modular design allows the rinser and knock-out brackets to be fitted to left or right, so we can tailor the layout to your espresso machine or barista preferences. The grinder support bracket adds rigidity to the grinder location and can be used on either side of the bar. An additional bracket can be fitted on the vacant side if a tap tower is required. Mounting points for the optional door and drawer configurations are built-in.

After welding, all modules have a zinc primer and a tough industrial polyester powder top-coat applied. The default frame colour is satin black, but a range of RAL colours is available as a custom option. The frame can be unbolted into flat-pack modules for storage or shipping as required, but is supplied fully assembled as standard.

- 1** Base module: steel, includes heavy-duty castor brackets and tow bar bracket
- 2** Top module: steel, allows for rinser and knockbar to be fitted on either side
- 3** Front support frame (pair): steel, receives utility brackets
- 4** Rear brace: steel, structural support locates magnetic door catch and key operated latch
- 5** Drawer module (pair): steel, receives stainless steel drawer runners and locking mechanism
- 6** Knock out bracket: aluminium, with 3 positions for the bolt-on acetal knock bar
- 7** Grinder support bracket: aluminium
- 8** Rinser support bracket: aluminium
- 9** Umbrella mount*: steel, for secure and quick clamping of umbrella *optional accessory
- 10** FCL1-Velo bracket*: for mounting FCL1-Velo espresso machine *optional accessory
- 11** Corner post (pair): aluminium, formed radius, supports branding panel at corners

STANDARD BAR

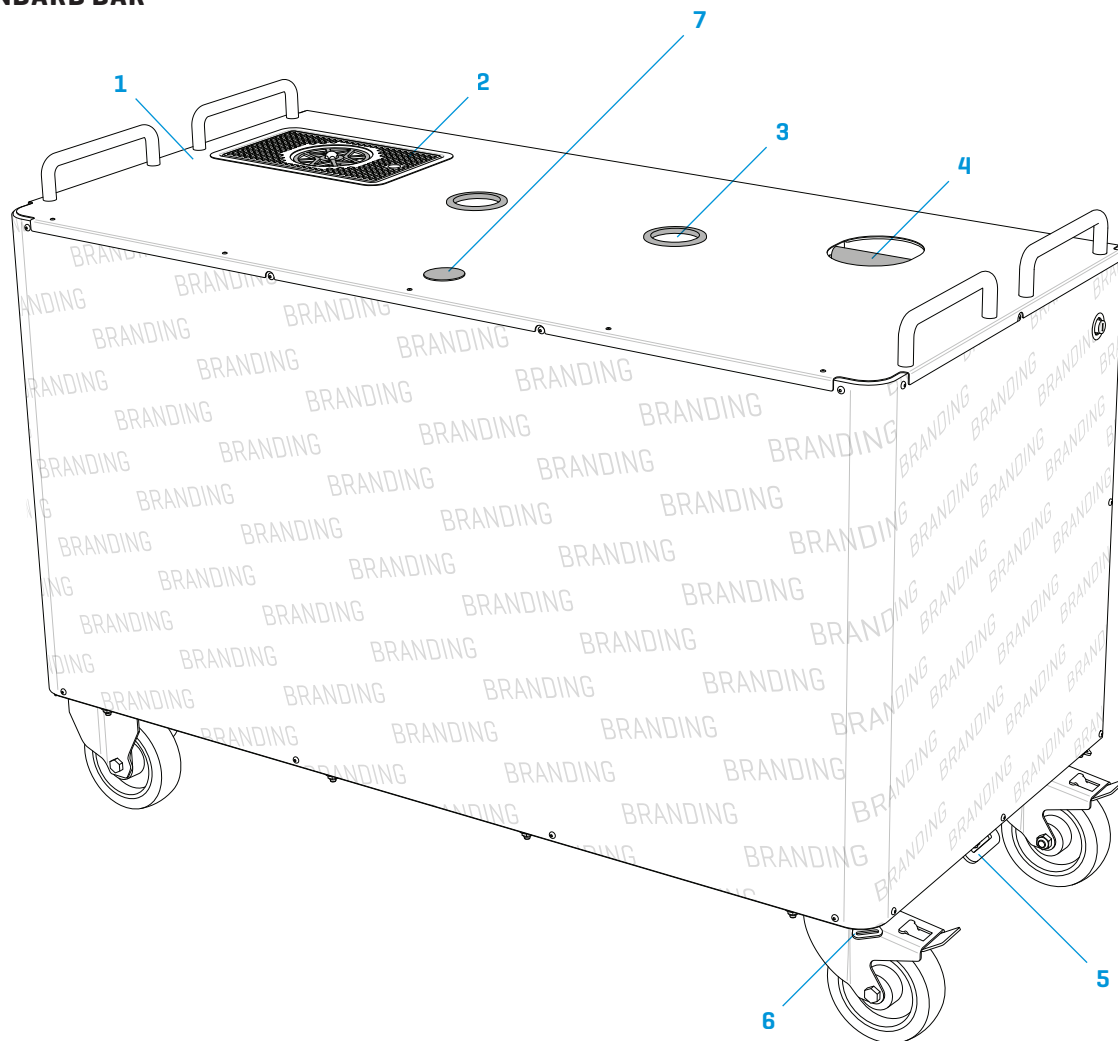

The laser-cut, heavy-duty stainless steel worktop is 1.2mm thick with a brushed satin finish providing a great-looking, tough and long-lasting hygienic work surface. A formed lip around all four sides protects the steel frame and neatly conceals the edge of the branding panels. An integrated Celli pressure rinser sink for rinsing and draining milk pitchers is fitted on either the right or left side of the bar with the integrated knock-out port on the opposite side depending on the espresso machine bias. The port for the umbrella (optional) can be covered with a blanking plug if an umbrella is not required. The base module is fitted with a stainless steel tow bracket and 4 transit brackets, while a webbing tow sling / pull strap and 4 camlock straps are supplied for pulling or winching the POP-UP BAR up ramps (optional accessory) into a van and securing while in transit.

- 1** Worktop*: heavy-duty, 1.2mm stainless steel (304), fitted with food-safe silicone and stainless steel rivets *custom options on request
- 2** Pitcher rinser: Celli recessed pitcher rinser with drip tray, 300mm wide, stainless steel
- 3** Ports: central ports (x2) with rubber grommet (ID Ø68 mm) for power cables and hoses
- 4** Knock bar: Ø22, black acetal, fixed with M8 bolt, 3 positions (front, middle, back)
- 5** Tow bracket: heavy-duty stainless steel (304), supplied with webbing tow sling / pull strap
- 6** Transit bracket: stainless steel, allows the bar to be secured in a van using the 4 x 25mm webbing camlock transit straps supplied
- 7** Umbrella port: included in the worktop, can be fitted with blanking plug if umbrella not used

STANDARD BAR

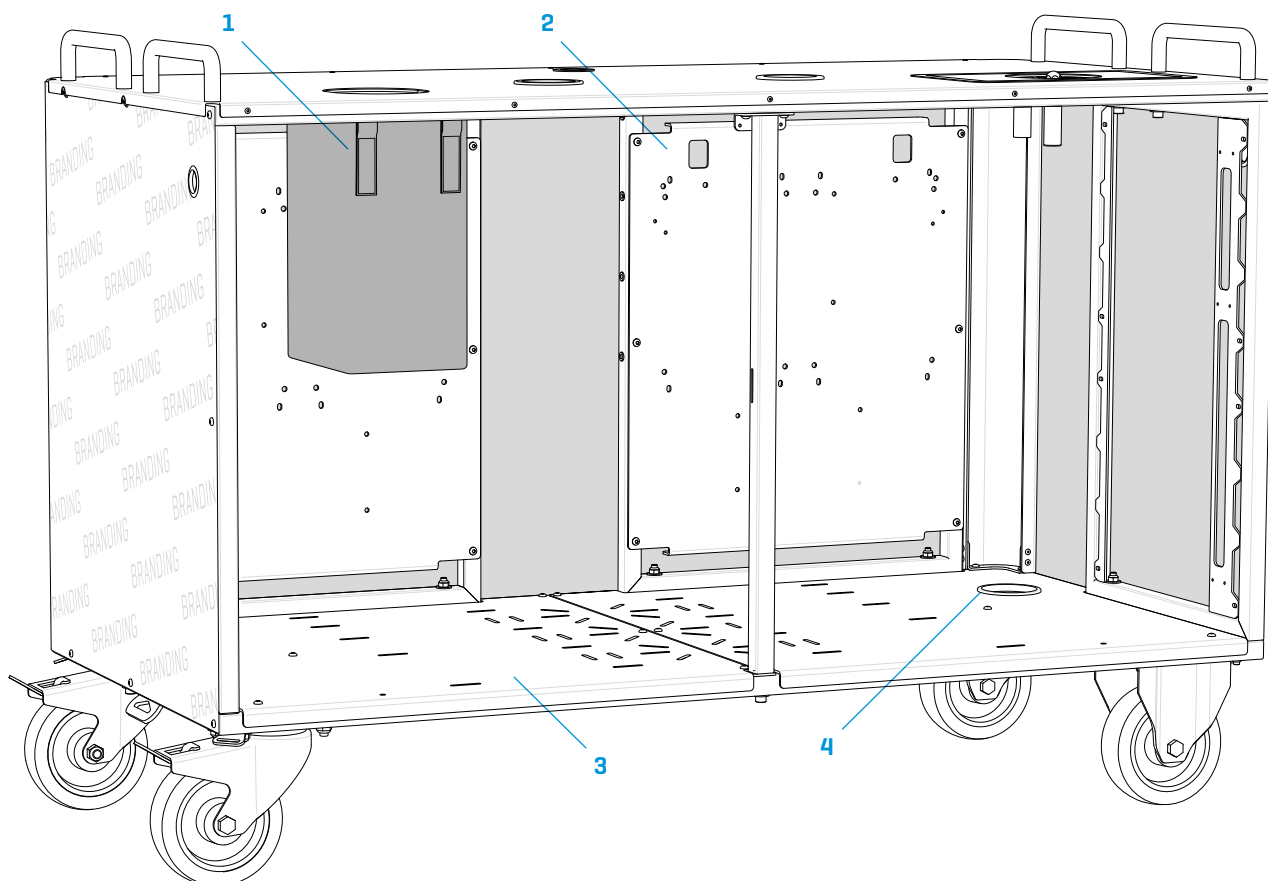

The POP-UP BAR interior is fitted with 3mm thick laser-cut aluminium floor and utility panels. The floor panels have slotting for securely strapping down the large items (water tanks, gas cylinder, etc.) in different configurations and for ventilation, and a lip to protect the frame; two ports with rubber grommets at the front corners allow mains electric cables to enter/exit under the bar. The utility panels are designed to securely locate all the plumbing on one panel and power components on the other with left and right side interchangeable depending on the orientation of the rinser; laser cut holes are in place to receive the plumbing kit we offer (optional), but the panels can easily be drilled to receive alternative components of your choice. The 11 litre, hard-wearing, water and heat resistant knock-bag is suspended on stainless steel hooks directly beneath the knock-bar and against the work surface, and is quickly removable for emptying when required and cleaning at the end of the day.

- 1** Knock bag: water and heat resistant, heavy-duty nylon fabric knock bag, 11L capacity holds over 300 pucks
- 2** Utility panel (pair): 3mm aluminium, laser cut and folded, for securely fixing all the plumbing and power components
- 3** Floor panel (pair): 3mm aluminium, laser cut and folded with strap slots for securing up to 3 x 25L water canisters, gas cylinder, battery and hand wash
- 4** Ports: ports (x 2) with rubber grommet (ID Ø76 mm) for routing power cables

OPTIONS: PLUMBING KIT

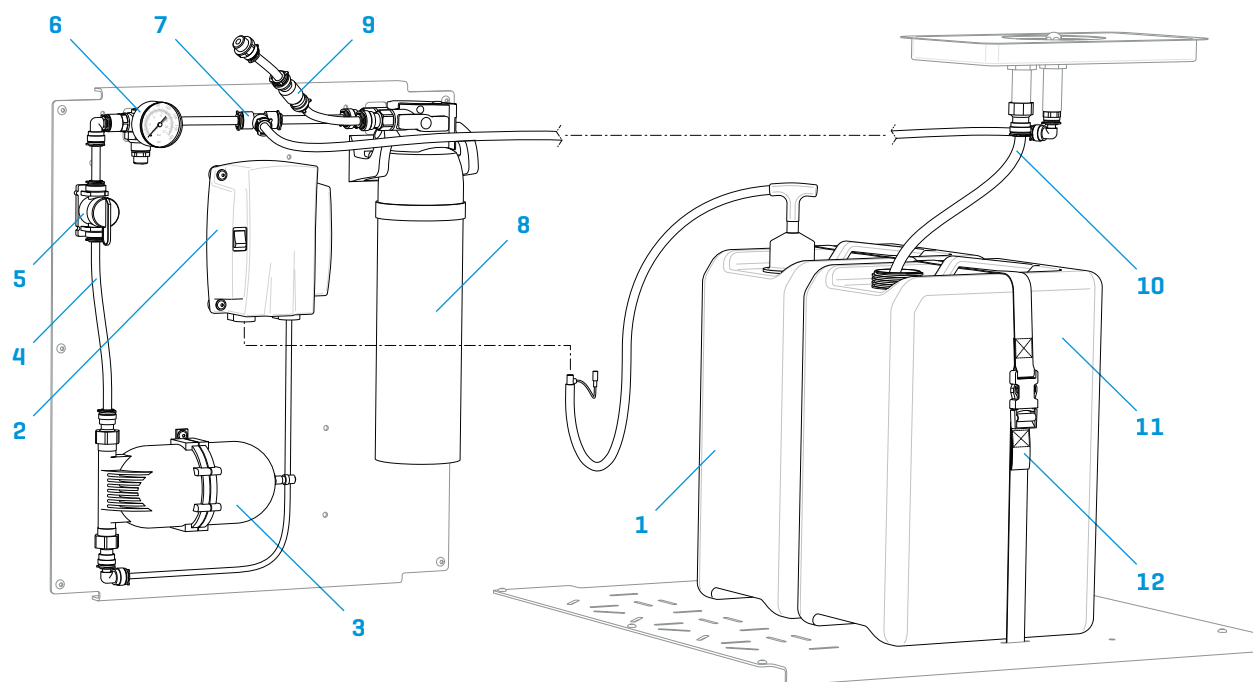

The plumbing kit (optional) is a complete system that just requires electrical power to provide filtered water to your espresso machine and a pressurised water jet to the rinser. If ordered, the kit is supplied fully installed and consists of: 2 x 25L canisters* (fresh water + waste) with quick-release snap buckle straps; a Flojet 5000 series pump with tank suction wand and auto shut-off; Shurflo accumulator; John Guest tube and fittings including a shut-off valve, check valve; pressure regulator valve with gauge; and a Brita Purity C150† filter and head; and all the connections to join up to the integrated Celli pitcher rinser. Also included are the waste connections from the rinser to the waste tank.

*additional canisters and straps can be purchased

† the larger C300 size is available as an optional upgrade

- 1** Fresh water canister: 25L, food safe, natural HDPE, fits Flojet suction wand, stackable
- 2** Water pump: Flojet 5000 series, 220V
- 3** Accumulator: Shurflo accumulator tank
- 4** Fresh water hose: John Guest, 3/8", blue LDPE
- 5** Shut-off valve: John Guest shut-off valve with mounting clip
- 6** Pressure regulator / gauge: Watts series P60-M1 water pressure regulator, with gauge
- 7** Equal Tee: John Guest, 3/8"
- 8** Filter: Brita Purity C150* cartridge, Brita Purity C 30% or C 0% head
*C300 size cartridge and 0-70% variable head available as upgrade options
- 9** Single check valve: John Guest, 3/8", check valve fitted to espresso machine water-IN hose
- 10** Waste hose: John Guest, 1/2", black LDPE or reinforced clear 14mm ID waste hose
- 11** Waste canister: 25L, natural HDPE, stackable
- 12** Canister straps: 2 x 25mm x 1.65m black webbing straps with QR snap buckles

OPTIONS: DOORS & COOLBOX DRAWERS

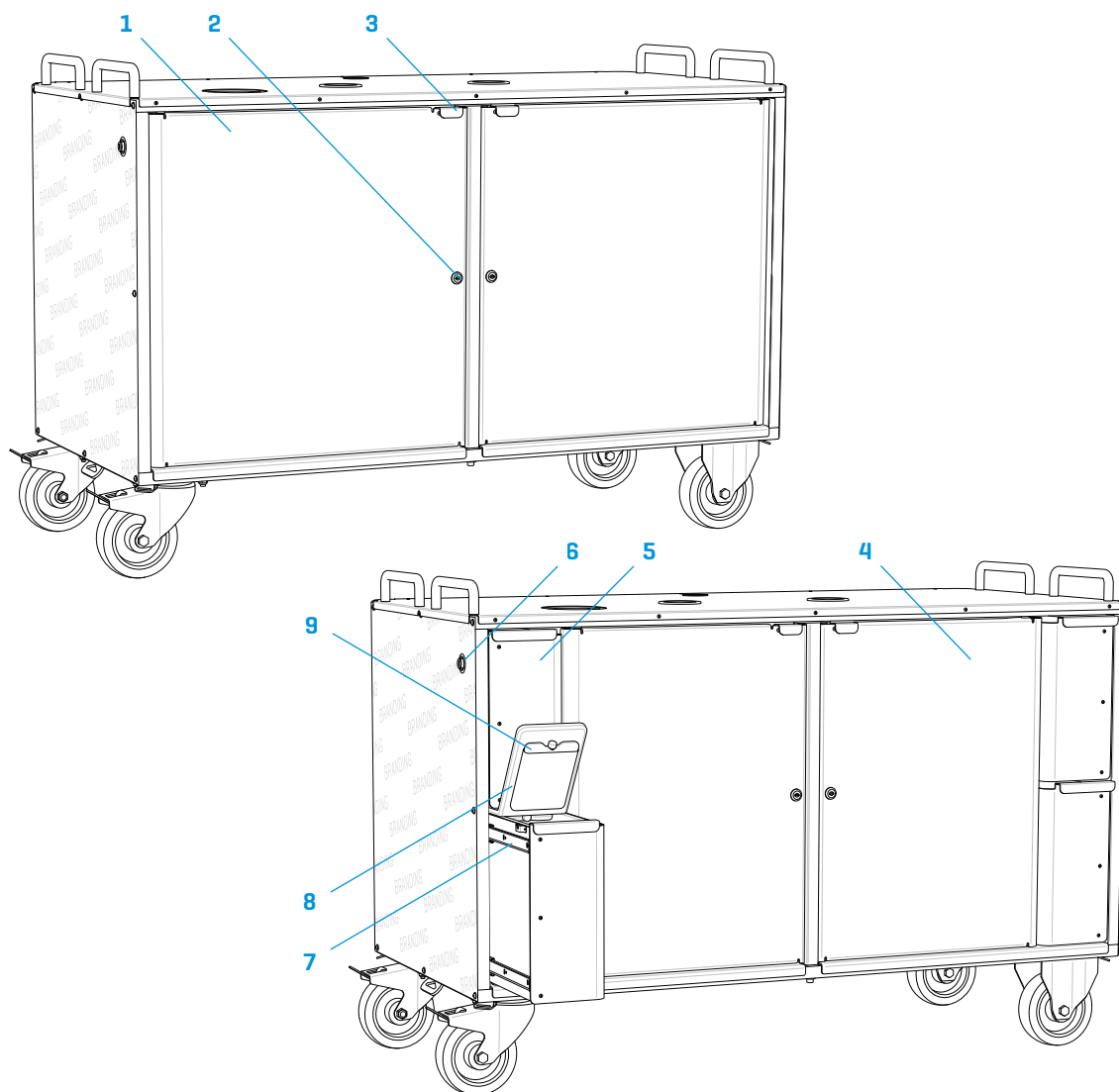

The POP-UP BAR can be fitted with a pair of elegant laser-cut and formed aluminium doors (optional), which are fitted with magnetic catches and key-operated locks. The choice is between large doors (top picture) or small doors if paired with the matching coolbox drawers. The aluminium coolbox drawers (x 4) were developed for the Velopresso trike and are supplied fitted with insulated liners and sets of ice packs. This system allows you to keep up to 24 litres of milk cool throughout a working day. The drawers are fitted with key-alike locks to match the doors and one lock on each side of the BAR secures a pair of drawers. Each drawer runs on a pair of full extension ball bearing runners and is quick to disconnect for cleaning and maintenance when required.

- 1** Large doors: 3mm aluminium, magnetic catch, key-lockable
- 2** Door locks: key-operated Symo3000 lock
- 3** Door handle: 2mm folded aluminium
- 4** Small doors: compatible with drawers, 3mm aluminium, magnetic catch, key-lockable
- 5** Drawers: 4 x aluminium, key-lockable drawers with insulated coolbox inserts for milk storage up to 24 litres (48 pints)
- 6** Drawer lock: Symo3000 central locking
- 7** Drawer runners: Accuride ball bearing drawer runner, front disconnect, full extension
- 8** Coolbox insert: insulated flat-pack drawer liners used with ice packs provide exceptional cold storage for milk
- 9** Ice packs: Kampa ice packs, 200ml (5 per drawer), fit precisely into the coolbox inserts

OPTIONS: BEVERAGE DISPENSE KIT

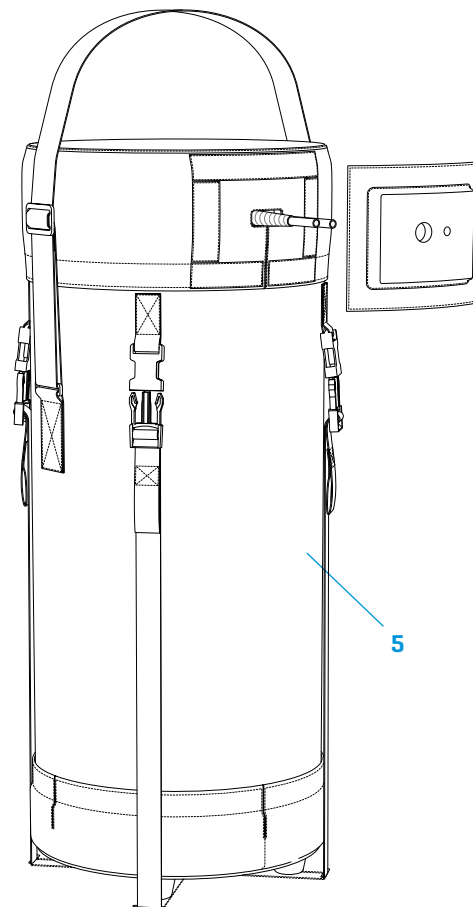
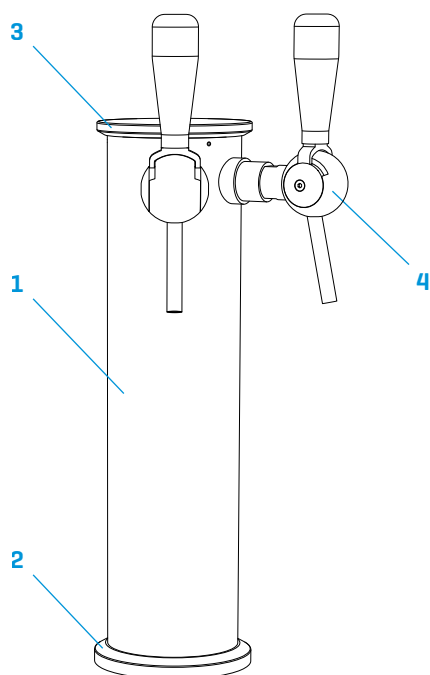

The POP-UP BAR can be fitted with our own premium quality beverage dispenser tap towers, for serving hot or cold drinks dispensed from insulated 19 litre (5 gal) ‘Cornelius Kegs’. The tap towers (Ø 104), are made from thick walled (2mm) stainless steel and are electropolished and insulated. The CNC-machined base and lid fit snugly around the tower with concealed fixings. A single tower (twin tap) can be added to a coffee bar set-up for serving cold brew or a dedicated tap bar can be set up with 2 or more towers offering a range of selected drinks. The thermal keg jackets provide the ultimate solution for keeping drinks at optimum serving temperature (hot or cold) throughout the day without the need for electricity or ice. Using insulation material used by NASA, the jacket significantly outperforms every other product on the market. We offer a complete system, including AEB kegs, air manifolds, keg connects and insulated hoses to complement the tap towers and jackets.

- 1** Tower – cylinder: stainless steel (304), Ø104mm (4”) x 428mm high (total assembled height)
- 2** Tower – base: CNC-machined from solid stainless steel (304), electropolished, diameter 125mm, concealed fixings
- 3** Tower – lid: CNC-machined from solid stainless steel (304), electropolished, removable, secured with food-safe silicone o-ring and stainless steel set screws
- 4** DebiTaps: stainless steel beverage dispense taps, by Antoine of Belgium, can be used for hot or cold beverages
- 5** Thermal Keg Jacket: uses insulation material used by NASA in astronauts’ suits and the Mars Rover; tough oxford weave nylon exterior, rubber feet, webbing straps secure the keg in position in the BAR

OPTIONS: UTILITIES

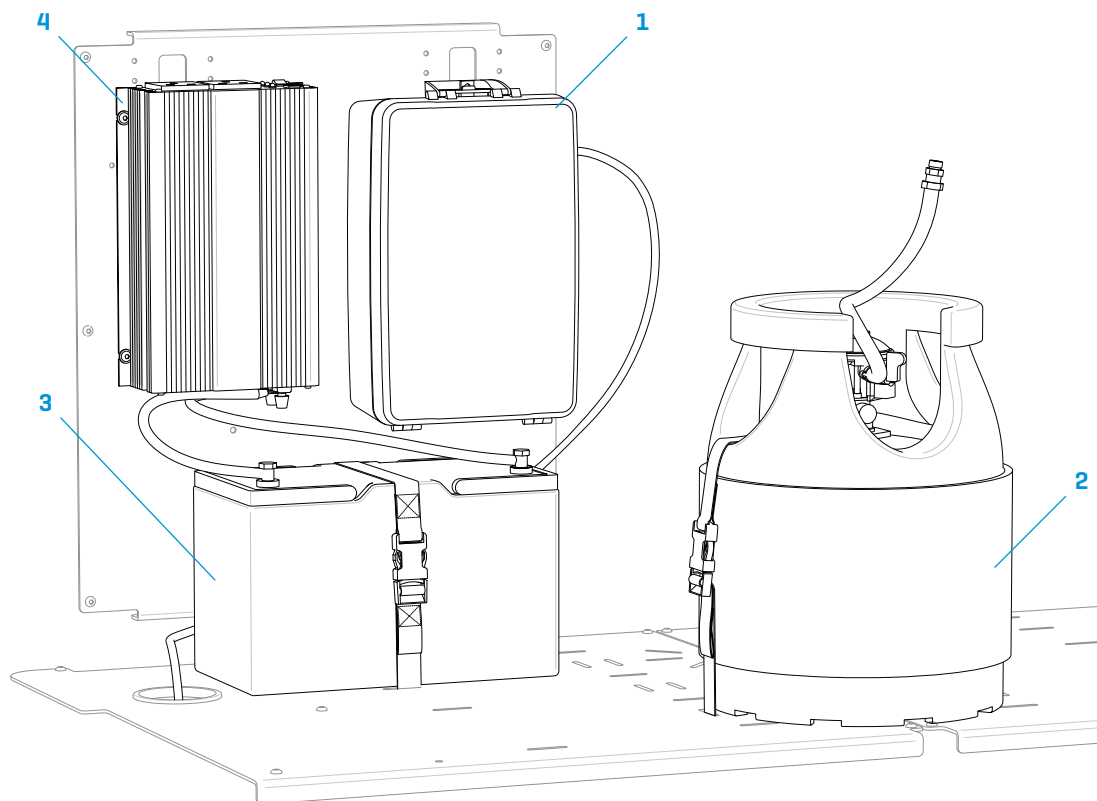

The POP-UP BAR is designed to receive power via a mains supply routed inside the bar through ports in the floor panels, or an off-grid supply. If you have a dual-fuel espresso machine (e.g. Fracino Retro or Contempo Dual Fuel models, or Velopresso FCL1-Velo) you can run your mobile coffee bar entirely off-grid, using a propane gas cylinder, plus a battery and inverter to power the grinder and pump. The IP54 power enclosure gives splash protection to the power connections where your mains-in feed (or battery/inverter feed) connects to your espresso machine, grinder and pump power supplies.

A Tealwash Handeman Xtra* portable hand wash unit provides an incredibly compact solution, meets with practical and legislative requirements and can easily be stored inside the bar.

*optional accessory

- 1** Electric socket box: IP54 power enclosure
- 2** Gas cylinder*: LPG gas, propane or butane cylinders from 1.8kg to 5kg (net) can be used. We recommend the lightweight fibreglass BP Gaslight 5kg propane cylinder for outdoor use
*the gas cylinder, regulator and gas hose must be sourced, fitted and certified locally, contact your GAS-SAFE engineer for details
- 3** Battery*: 104Ah 12V gel battery, sealed, rechargeable
- 4** DC-AC power inverter*: 12V to 240V, 100A, 1kW *a 2kW inverter may be required in some instances
- 5** Tealwash Handeman Xtra portable hand wash*: robust and compact portable sink, for use with pre-heated hot water, keeps water warm for 5 hours and provides a minimum of 15x 10-second hand washes per filling
*the 12V DC electrically heated versions also available

DIMENSIONS

